

REV.	DATE	DCN #	DRAWING TREE #
A	28 MAR 2008	E080113-00	

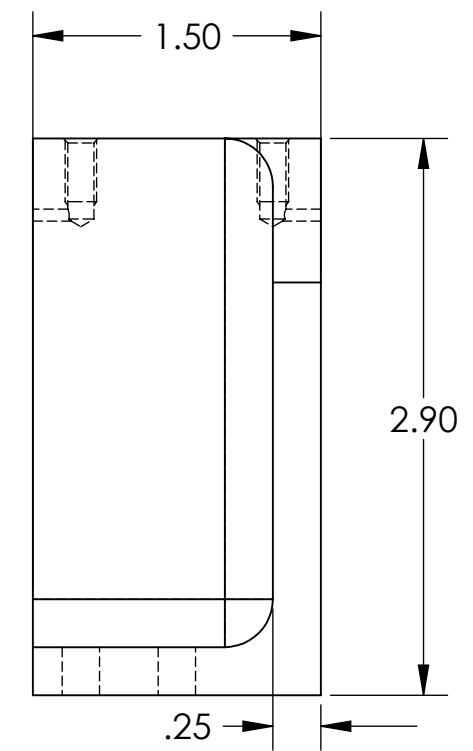
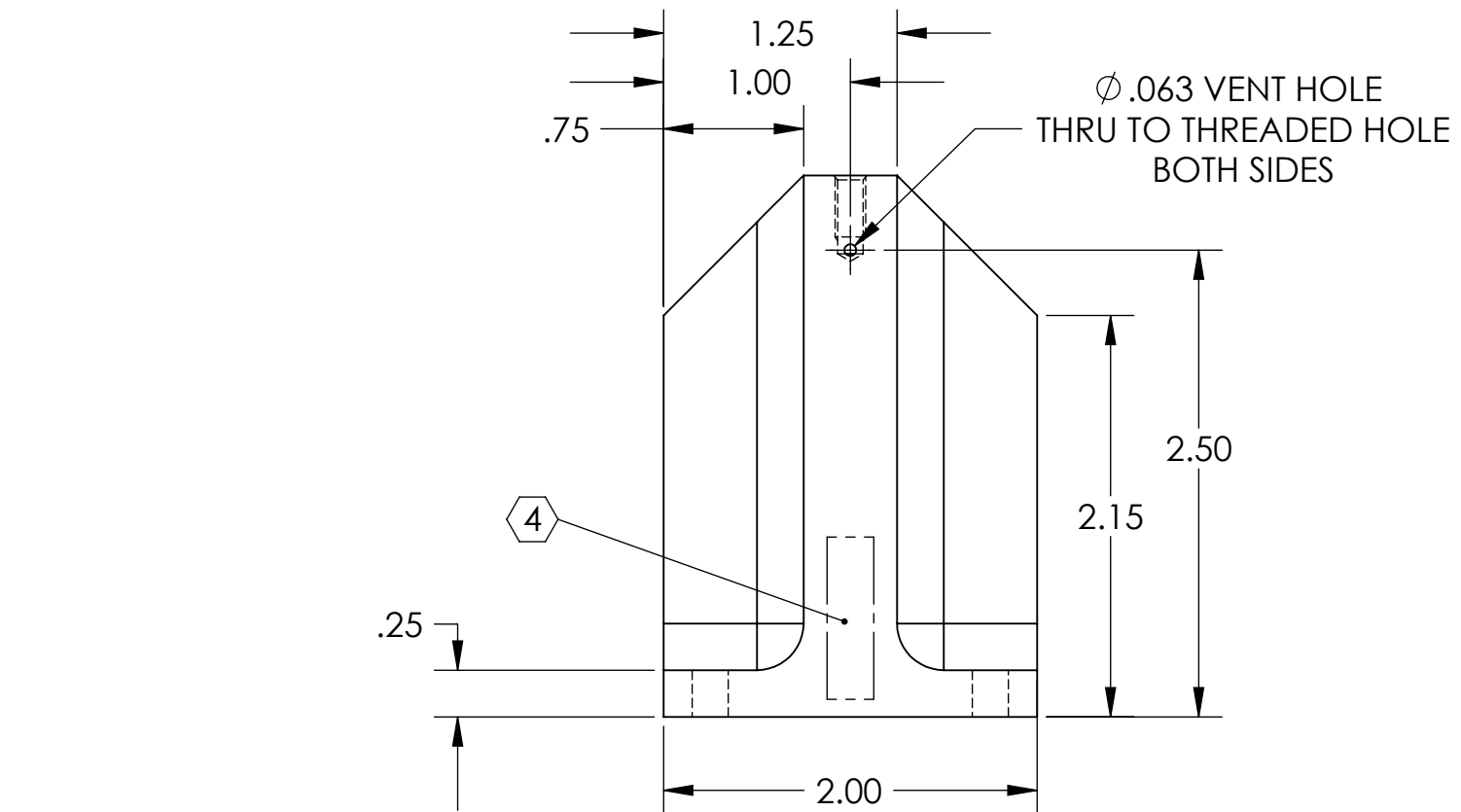
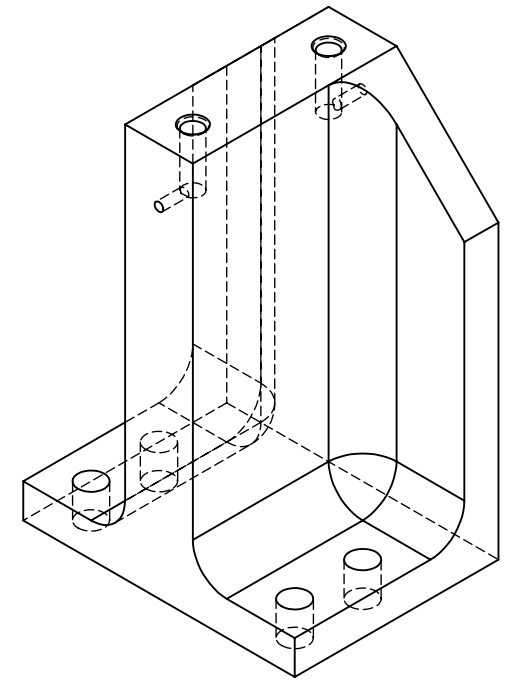
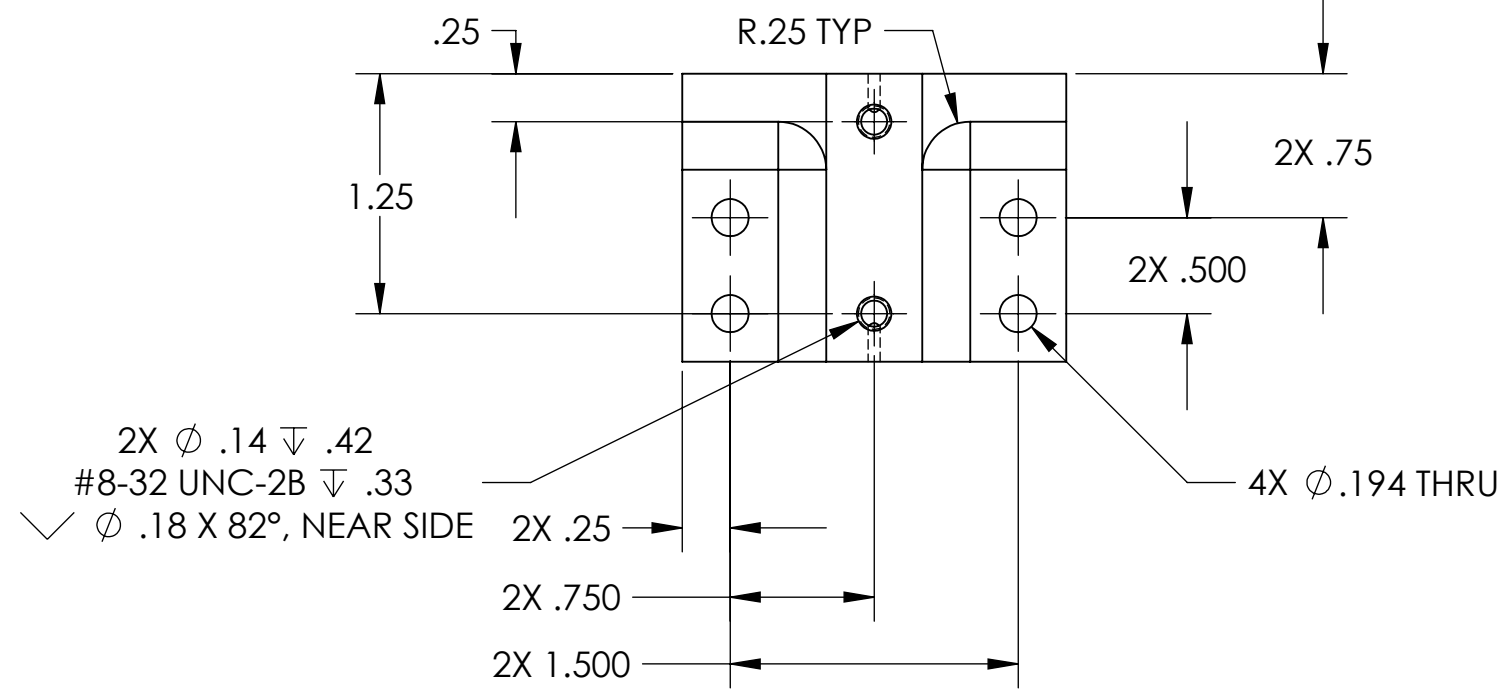

**NOTES: (UNLESS OTHERWISE SPECIFIED)**

- DO NOT SCALE FROM DRAWING.
- REMOVE ALL SHARP EDGES, R.02 MAX.
- ALL MACHINING FLUIDS SHALL BE WATER SOLUBLE AND FREE OF SULFUR, CHLORINE AND SILICONE.
- SCRIBE, ENGRAVE OR MECHANICALLY STAMP DRAWING (NO INKS OR DYES) PART NUMBER, REVISION ON NOTED SURFACE OF PART FOLLOWED ON THE NEXT LINE WITH A THREE DIGIT SERIAL NUMBER. SERIAL NUMBERS START AT 001 FOR THE FIRST ARTICLE AND PROCEED CONSECUTIVELY. USE .12" HIGH CHARACTERS, UNLESS THE SIZE OF THE PART DICTATES SMALL CHARACTERS. A VIBRATORY TOOL MAY BE USED, EXAMPLE: D050XXX-A S/N 001

DIMENSIONS ARE IN INCHES  
TOLERANCES:  
.XX ± 0.01  
.XXX ± 0.005  
ANGULAR ± 0.5°

<b>MATERIAL</b>		6061-T6 AL
<b>FINISH</b>		32 $\mu$ inch
<b>DRAWN</b>	C. ECHOLS	24 APR 2007
<b>CHECKED</b>	M. MEYER	26 MAR 2008
<b>APPROVED</b>		

**PARTS LIST**

CALIFORNIA INSTITUTE OF TECHNOLOGY MASSACHUSETTS INSTITUTE OF TECHNOLOGY IGR, GLASGOW UNIVERSITY GEO 600 GROUP	
SYSTEM	ADVANCED LIGO
SUB-SYSTEM	SUS
NEXT ASSY	D070145
PART NAME	
BLADE GUARD RISER, OMC	
SIZE DWG. NO.	B D070147
SCALE: 1:1	PROJECTION:
SHEET 1 OF 1	